

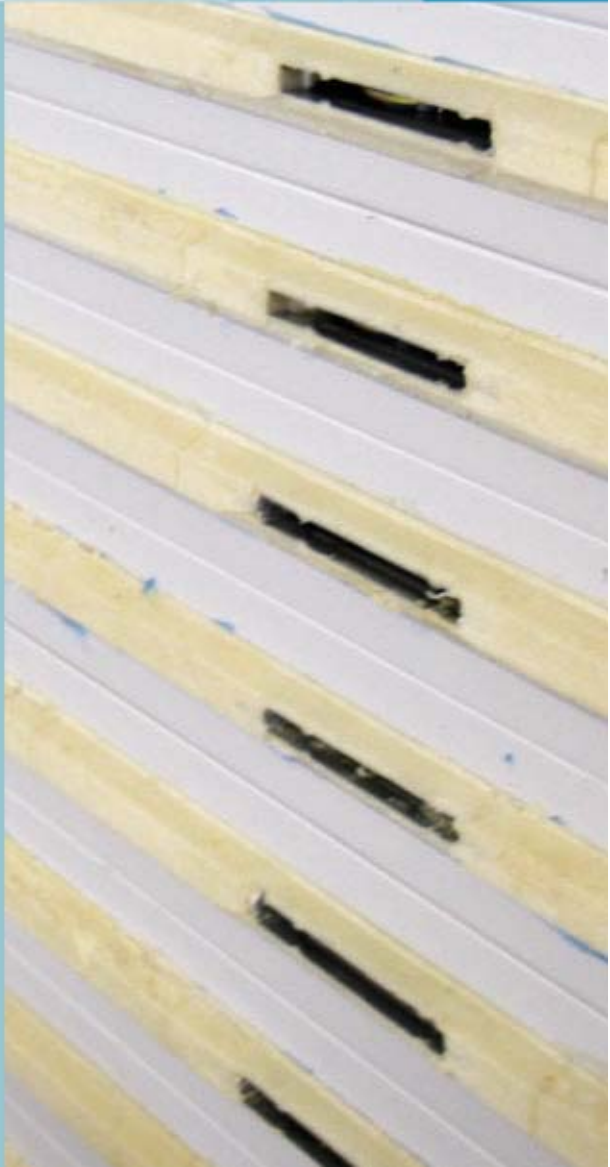

FRIGAIR

WE TRUST ON QUALITY MORE THAN QUANTITY

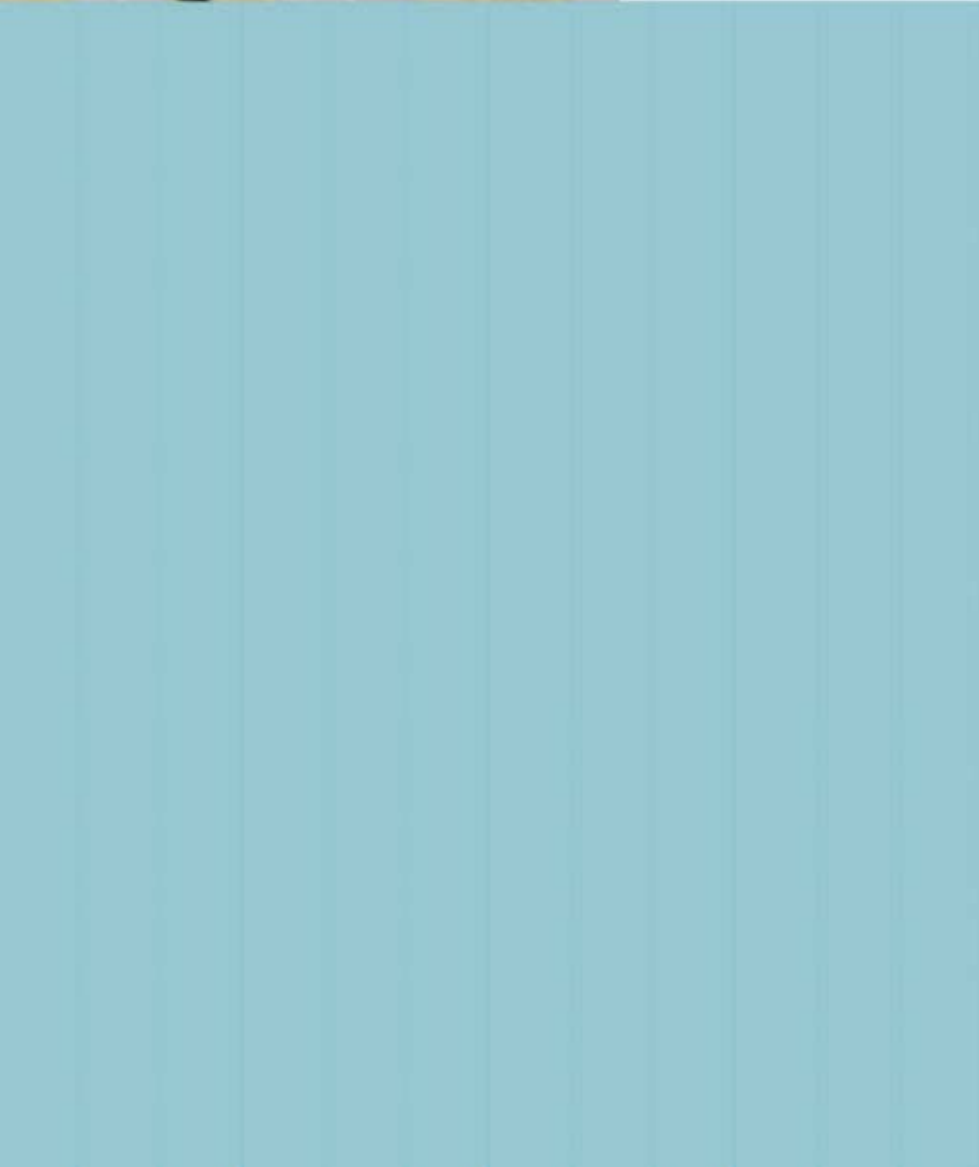

The logo for FRIGAIR, featuring the word "FRIGAIR" in white, bold, sans-serif capital letters on a blue rectangular background.

FRIGAIR SDN BHD, history goes back into 1986, when it was establish as a Wholesaler in Refrigeration and Air-Conditioning Spare Parts and Equipment. Three [03] years later, the Company purchase a factory at Tampoi, Johor Bahru to cater for the ever increasing demands locally and oversea market. This followed with another challenges in 1990, to manufacture and assemble the Condenser and Heat Exchanger.

Strong demands for the Condenser Coil and relates products lead to further expansion. In 1992 our manufacturing plant was relocate to a new One [01] hectare factory with advance machinery and equipments to meets the changing technological standard.

1995, marks yet another milestone for us with the establishment of FRIGWALL, which is the Prefabricated Modular Rigid Closed Cell Polyurethane Coldroom Panel, caters for the Commercial, Industrial & Integrated Warehouse Cold-room, Clean-room, Supermarket, Restaurants and Catering Service. The other specialized service renders are the installation and after sale services.

In order to guarantee for high quality standard, we brought in millions dollars worth of advanced machinery such as the "High Pressure Injection" PUR Metering Machine called 'PUROMAT' and other related accessories.

VISION & COMMITMENT

Our vision is to provide prompt, quality services to our valuable customers and become the best and largest supplier in the world.



FRIGAIR PROJECT



• FRIGAIR DOORS • FRIGAIR DOORS • FRIGAIR DOORS • FRIGAIR DOORS • FRIGAIR DOORS • FRIGAIR DOORS • FRIGAIR DOORS •

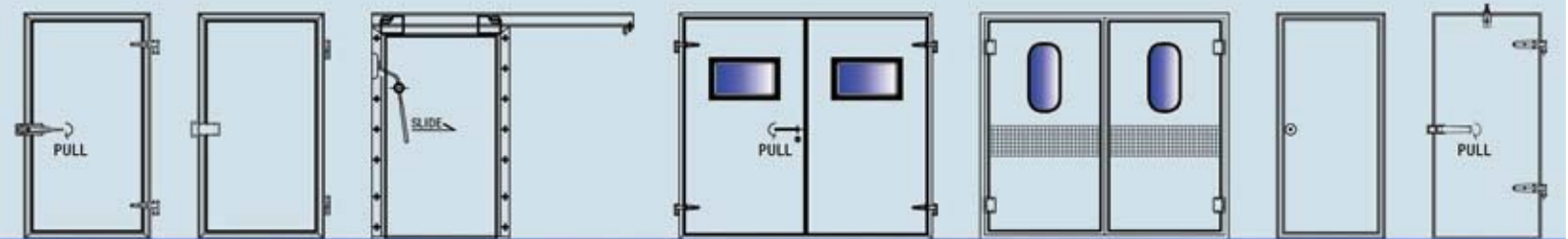

HALF EXPOSED SWING DOOR ONE LEFT KASON ACCESSORIES |
 HALF EXPOSED SWING DOOR ONE LEFT FERMOD ACCESSORIES |
 SLIDING DOOR DANDOORS ACCESSORIES |
 HALF EXPOSED DOUBLE SWING DOOR IMPORTED ACCESSORIES |
 INSULATED FLIP-FLAP DOOR IMPORTED ACCESSORIES |
 OFFICE FACTORY DOOR |
 FLUSH DOOR C/W DOOR CLOSERS

FRIGAIR JOINTINGS

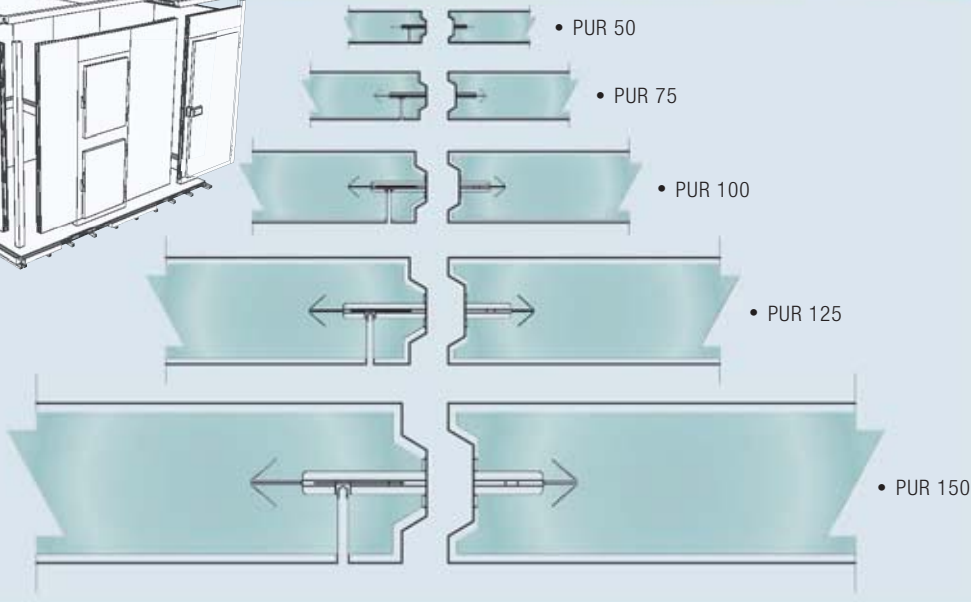
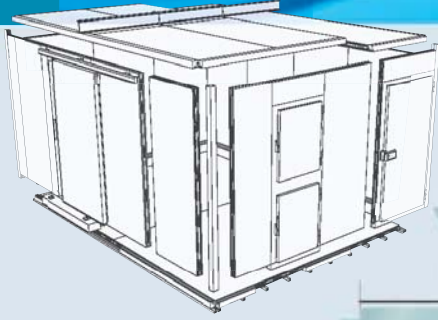

PUR PANEL CEILING SUSPENSION

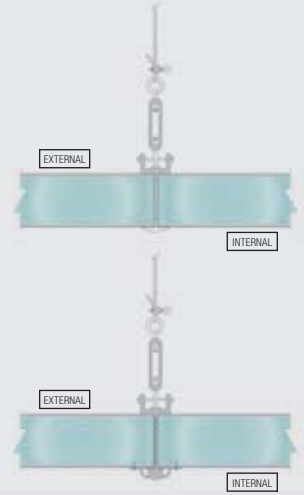

• FULLY CAM LOCK SYSTEM • FULLY CAM LOCK SYSTEM • FULLY CAM LOCK SYSTEM •

• PUR PANEL JOINING FINISHING • PUR PANEL JOINING FINISHING • PUR PANEL JOINING FINISHING • PUR PANEL JOINING FINISHING •

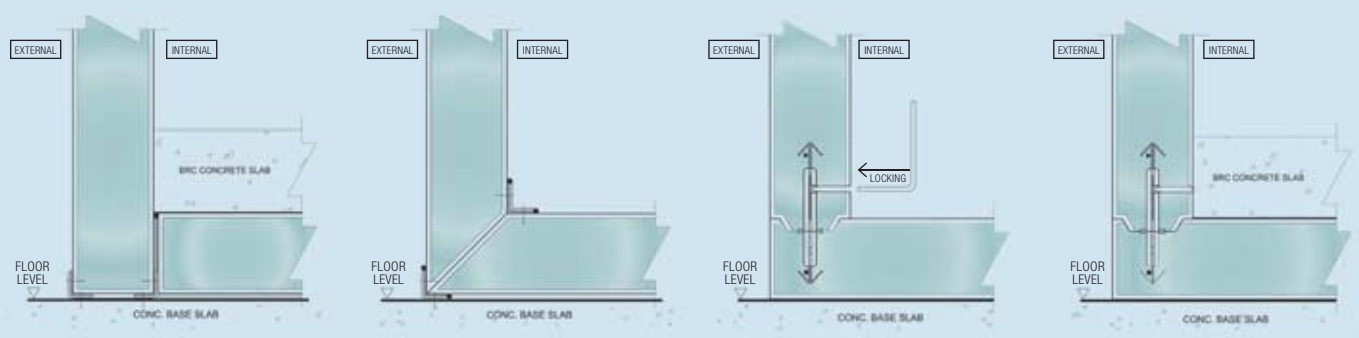
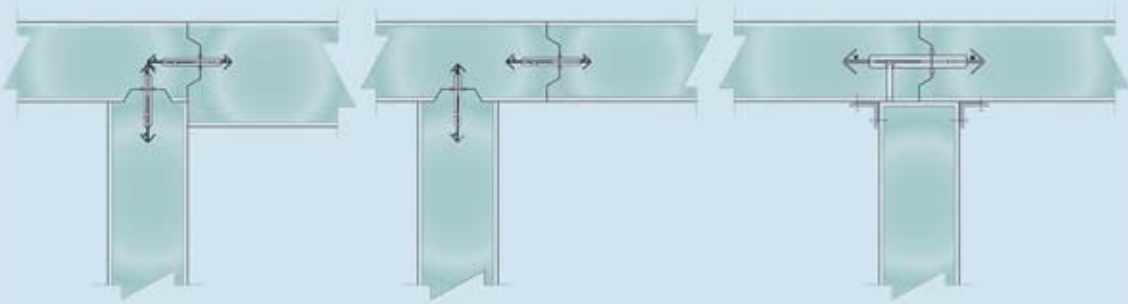
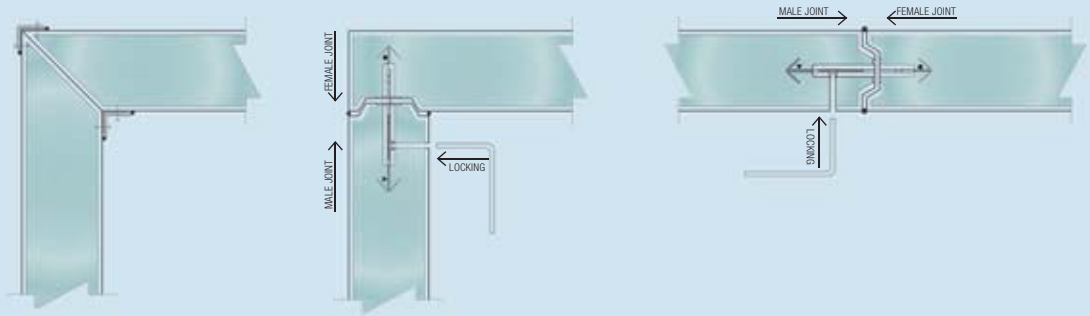

TYPES:	High Pressure Injected, Prefabricated Modular Expanded Rigid Closed Cell Sandwich Polyurethane [PUR] Panels.
DESCRIPTION:	<p>FRIGAIR Prefabricated Modular PUR Panel comprise of two pieces steel skin, in between it injects PUR [Insulated Composite] by PUROMAT High Pressure Polyurethane Foam Injection Machine, cured and harden within the custom mould, thus creates a completed shaped Insulated Sandwich Panel.</p> <p>The FRIGAIR PUR Panels jointing are constructed with the well known profile "tongue & groove", with the heavy duty mechanically operate Cam-Lock system which is foamed within [in-situ]. The spacing distance varies of interval 300mm to 600mm depends with each Panel's thickness.</p> <p>FRIGAIR panels have turned safety edges. The panel to panel locking, in-between it, is the non-drying polybutene sealant and the external gaps seals off with silicone sealant for a clean hygiene surface.</p> <p>The FRIGAIR Full Mechanical Cam-Locking system is very useful application, should it require moving to a new location [relocation] it removes with ease and without damaging the panels and the edges.</p>
FIRE PERFORMANCE:	The polyurethane foam within the panels is fire retardant to BS4735:1974, it is also classified as 'P', not easily ignitable when tested to BS476: part 5: 1979. Please note that polyurethane is combustible when exposed to flame and could contribute to the spread of fire. The polyurethane panel is not a fire resistant panel. FRIGAIR accepts no liability for the suitability of this product for your project.
THICKNESSES:	<p>PUR 50 = 50mm</p> <p>PUR 75 = 75mm</p> <p>PUR 100 = 100mm</p> <p>PUR 125 = 125mm</p> <p>PUR 150 = 150mm</p>
SIZES:	<p>Maximum Width: 150 to 1180mm.</p> <p>Maximum Length: 1000 to 9000mm.</p>
PANEL FACING:	<p>FRIGAIR panels can be manufactured with a number of facings:</p> <p>A) Either that of: 'Plain & Smooth' or Ribbed Vertically at 100mm interval.</p> <p>B) The "Colorbond" [Pre-painted Galvanized Steel Sheet]. Steel Thickness: 0.50mm. Color: Milky White. Polyester Lacquer, 25 micron, suitable for food process purpose.</p> <p>C) The Stainless Steel [AISI 304 / 2B]. Steel Thickness: 0.50mm. Or 0.7mm.</p>
INSULATION:	<p>FRIGAIR HFC rigid closed cell expanded polyurethane foam [CFC-Free] insulation consist of two chemical components and blowing agent. The insulation is manufactured from Polyol and Isocyanate. The Insulation Core Properties:</p> <p>A) Density: 40 – 45 Kg/M3.</p> <p>B) Thermal Value: W / m2k. PUR 50 = 0.020 PUR 75 = 0.018 PUR 100 = 0.017 PUR 125 = 0.015 PUR 150 = 0.014</p> <p>C) Compressive Strength: 180 - 250KPa</p> <p>D) Tensile Strength: >300KPa</p> <p>E) Water Absorption: <2% / Vol.</p> <p>F) Operating Temperature: -50°C to +50°C [Degree Celsius]</p>
WEIGHT:	<p>The average data are as followed:</p> <p>PUR 50 – abt. 900 gm. / Sq. Ft.</p> <p>PUR 75 – abt. 1000 gm. / Sq. Ft</p> <p>PUR 100 – abt. 1100 gm. / Sq. Ft</p> <p>PUR 125 – abt. 1200 gm. / Sq. Ft</p> <p>PUR 150 – abt. 1300 gm. / Sq. Ft</p>
APPLICATION:	<p>The range varies with different thickness:</p> <p>PUR 50 – Positive Temperature. [<+10 Degree Celsius]</p> <p>PUR 75 – Positive & Negative Temperature. [< -05 Degree Celsius]</p> <p>PUR 100 – Negative Temperature. [< -25 Degree Celsius]</p> <p>PUR 125 – Negative Temperature. [< -30 Degree Celsius]</p> <p>PUR 150 – Negative Temperature. [< -50 Degree Celsius]</p>
ACCESSORIES:	<p>The standard material required:</p> <ul style="list-style-type: none"> > Locked handle with internal releasing latch with glow knob. > Hinges with self lifting. Option to select with spring loaded. Door closer. > Sliding door full specification with utmost performance. > Pressure Relief Port meant for Freezer Room, Quantity depends on size of the room. > Ceiling Support Aluminum Rail and Nylon 66 suspension cone. > Aluminum Treat Plate [Checkered Plate]. > Stainless Steel Treat Plate [AISI Checkered Plate].



Malaysia Office

Frigair Sendirian Berhad

No.12, Jalan Dewani,
Off Jalan Tampoi,
81100 Johor Bahru,
Johor, Malaysia.

Tel: +607-3320 830

+607-3336 915

Fax: +607-3326 682

Email: sales@frigair.com.my
frigair@streamyx.com

Singapore Office

Central Refrigeration & Airconditioning Pte Ltd

136, Rangoon Road,
Singapore 218414.

Tel: +65 6292 0011

Fax: +65 6295 1733

www.frigair.com.my